

**WONDER**  
*Since 1988*

# WONDER木工机械专用电机

Wonder Electric Motors For Woodworking Machinery

**目 录 CONTENT**

**产品及优势介绍**

**Introduction of Products and Advantages**

**主要应用设备**

**Main Applications**

**技术参数**

**Technical Characteristics**

**产品外形图**

**Outline Drawings**

## 产品及优势介绍

Introduction of Products and Advantages

**WONDER**  
Since 1988

木材的开发、加工与使用，和人类社会生活的各方面都息息相关，木工机械也因此成为社会广泛使用的种类加工设备之一。伴随着科学技术的不断发展、大众生活水平的快速提高，我国木工机械装备也得到了更多的发展机会。

为适应木材加工机械的发展特点，Wonder自主研发木工机械专用高效单、三相异步电机，广泛应用于原木加工机械、板材制造机械、家具及家装制造机械等多类型木材加工机械，为木工机械提供强大的动力，显著提高木材生产企业的生产效率。



The woodworking industry and all aspects of human social life are closely related. Therefore, woodworking machinery has become one of the widely used types of processing equipment. With the continuous development of science, technology and the whole society, woodworking machinery equipment has gained more opportunities for improvement.

In order to adapt to the development of wood processing machinery, Wonder has designed high efficiency single and three-phase asynchronous motors, widely used in log processing machinery, plate making machinery, furniture and decoration manufacturing kinds of wood processing machinery, to provide powerful impetus for woodworking machinery, significantly increasing the productivity of the enterprises.



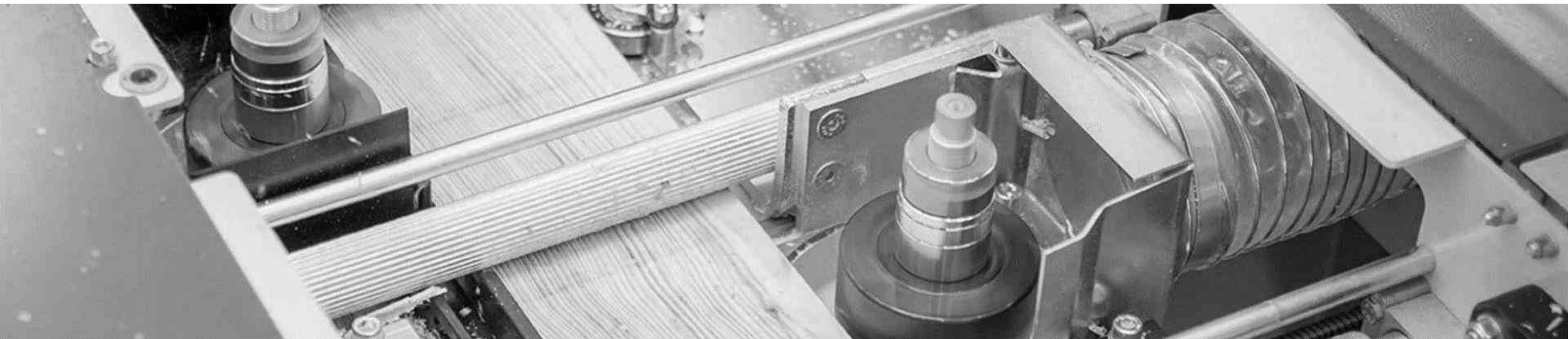

### 低振动、低噪音 Low Vibration & Low Noise

减振、降噪是木工机械设计制造的关键目标之一，振动和噪音水平不仅影响操作环境，也会影响机械工作效率。Wonder电机转子采用半键动态平衡，其振动程度符合GB/IEC标准的最优等级，同时也显著降低了噪音分贝。

Vibration and noise reduction is one of the key objectives of woodworking machinery design and manufacturing. Vibration and noise levels not only affect the operating environment, but also affect the efficiency of machinery. The rotor of Wonder motors adopts half key dynamic balance. Its vibration degree conforms to the optimal level of GB/IEC standards, and at the same time significantly reduces the noise.

### 防尘、耐腐蚀 Dust proof & Corrosion Resistance

木材加工机械在运作过程中将不可避免地产生大量木屑、粉尘，在部分木材加工环节中，还将使用到某些刺激性或毒性涂料。Wonder木工机械专用电机均采用铝制外壳，并按照IP55防护等级进行设计，可适应粉尘、潮湿或刺激环境。

Wood processing machinery in the operation process will inevitably produce a lot of dust. In part of the wood processing links, some irritating or toxic coatings will be used. Wonder motors for woodworking machinery all adopt aluminum frame and designed according to IP55 protection grade, which can adapt to dust, humidity or stimulating environment.

## 产品及优势介绍

Introduction of Products and Advantages

**WONDER**  
Since 1988



### 高转矩 High Torque

针对木材切割工具而言，高转矩是最重要的设备性能之一。Wonder木工电机定子采用高密度漆包线设计，确保了电机本身高水平的机械和电气强度，为木材加工机械带来强大的动力。

High torque is one of the most important equipment properties for wood cutting tools. Wonder woodworking motor stator is designed with high density enameled wire, ensuring high levels of mechanical and electrical strength for woodworking machines.

在未来，木材行业的发展将产生产业化、大型化、规模化等特点，环保节能将成为木工机械行业最重要的指标之一。作为国内外知名的高效电机供应商，Wonder自主研发的木工电机具有结构紧凑、重量轻、外形美观等优点，功率密度更高。在GB及IEC标准中，均实现了同等效率等级下的更高能效。

In the future, the development of wood industry will be featured with industrialization, large-scale, and other characteristics. Thus environmental protection and energy saving will become one of the most important indicators of the industry. As a professional supplier of high efficiency motors, Wonder developed independently the motors for woodworking machinery, having the advantages of compact structure, light weight, beautiful appearance and higher power density. In GB and IEC standards, higher energy efficiency under the same efficiency class is achieved.



### 高效节能 High Efficiency & Energy Saving

## 产品及优势介绍

Introduction of Products and Advantages

**WONDER**  
Since 1988

### 主要电气特性

### Main Electric Specifications of Motors

防护等级 Protection Class: IP55

绝缘等级 Insulation Class: F

温升等级 Temperature Rise Class: B

工作制 Duty: S1

额定电压 Rated Voltage: 380V/220V

额定频率 Rated Frequency: 50Hz

运行环境温度 Ambient Temperature: -20°C~40°C

运行海拔 Altitude: ≤1000m

冷却方式 Cooling Method: IC411/IC416





前/后上料高速裁板锯  
Front/Rear Feed Panel Diving Saw





**精密推台锯**  
**Precision Panel Saw**



**数控推台锯**  
**CNC Panel Saw**





**自动封边机**  
**Automatic Edge Bander**



**数控钻孔中心**  
**CNC Drilling**



**开槽机**  
**Nesting Workstation**

# 技术参数

Technical Characteristics

**WONDER**  
Since 1988

型号 Motor Type	功率 Rated Power	电压 Voltage	额定转速 Rated Speed	电流 Full Load Current	效率 Efficiency	功率因数 Power Factor	额定转矩 Rated Torque	堵转电流 额定电流 Locked Rotor/ Current	堵转转矩 额定转矩 Locked Rotor/ Torque	最大转矩 额定转矩 Break-down Torque
	kW	V	r/min	A	%	Cosp	N.m	Is/In	Ms/Mn	Mk/Mn
RMS8022	1.1	380	2840	2.58	76.2	0.85	3.70	7.0	2.5	2.5
RMS8032	2.2	380	2770	4.80	81.0	0.86	7.58	7.0	2.5	2.5
MS90L2	2.2	380	2840	5.30	80.0	0.79	7.39	7.0	2.5	2.8
MS100LC2	4.0	380	2880	8.10	84.2	0.89	13.20	7.5	2.3	2.5
RMS112MC2	5.5	380	2910	11.50	85.0	0.86	18.04	7.5	2.3	2.3
MT132SB2	11	380	2910	21.40	88.0	0.89	36.10	7.5	2.2	2.4
MT132SC2	15	380	2910	30.10	88.7	0.85	49.22	9.0	2.5	2.5
MT132MD2	18.5	380	2930	35.50	89.5	0.88	60.29	9.0	2.5	2.5
SWEA112-2	4.0	380	2900	7.75	88.8	0.88	13.17	8.0	2.6	3.0
SWEA132S1-2	5.5	380	2930	10.6	89.9	0.89	17.93	8.9	2.4	3.7
SWEA132S2-2	7.5	380	2930	13.9	90.8	0.90	24.44	9.0	2.4	3.5
RMC8022	0.75	220	2790	5.90	73.0	0.79	2.56	6.2	2.5	1.8
ML100L2	3.0	220	2820	17.30	83.0	0.95	10.15	6.4	1.7	1.7

产品外形图  
Outline Drawings

RMS8022 B3

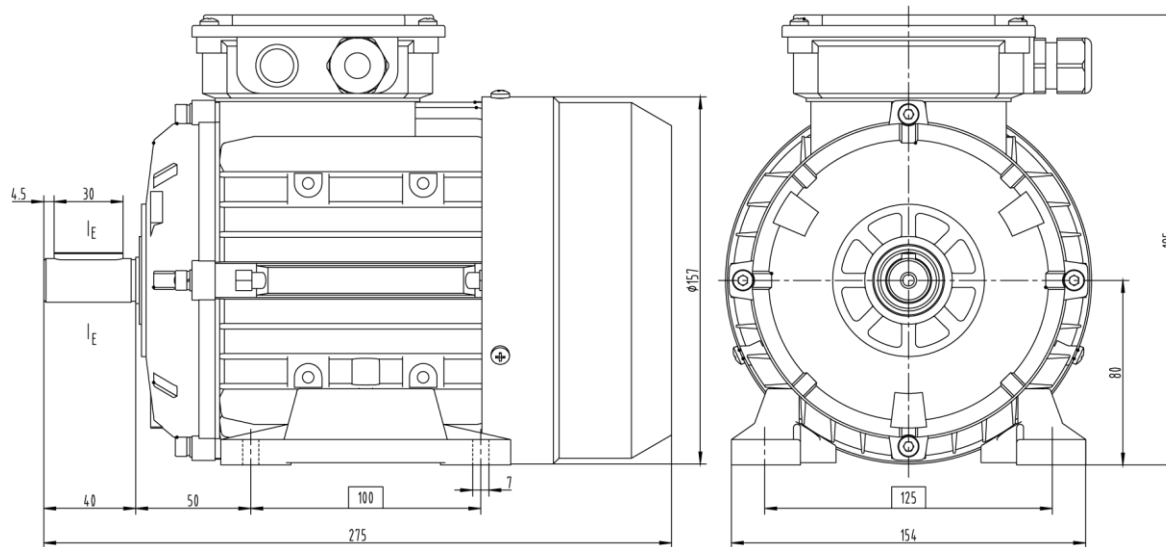

RMS8032 B14

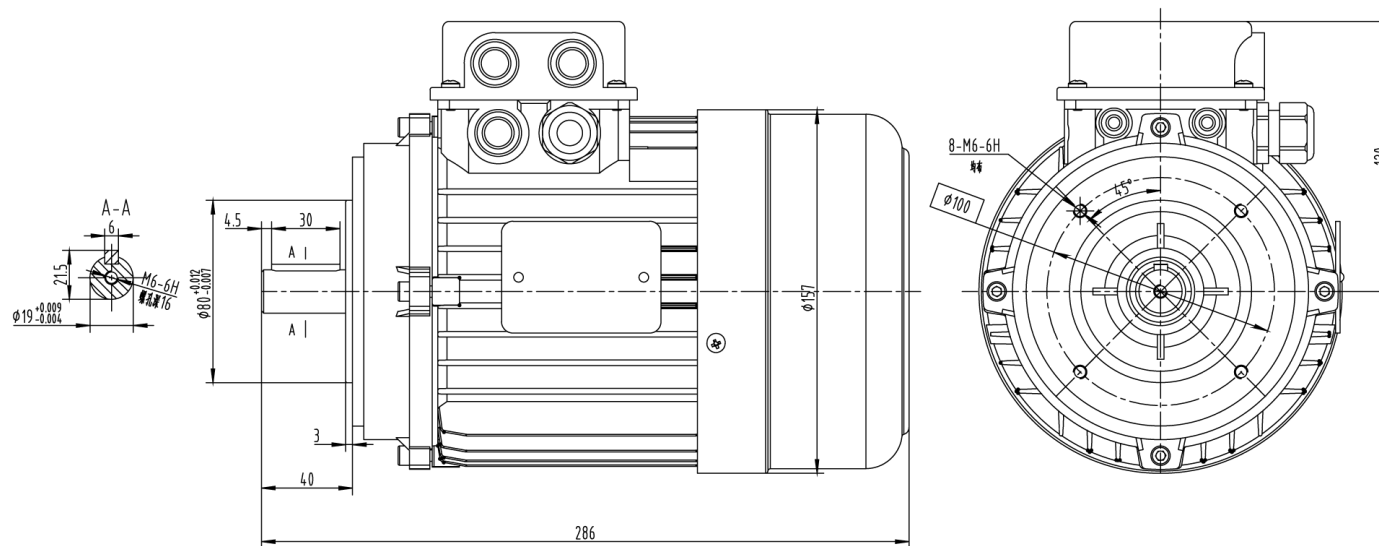

产品外形图  
Outline Drawings

MS90L2 B5

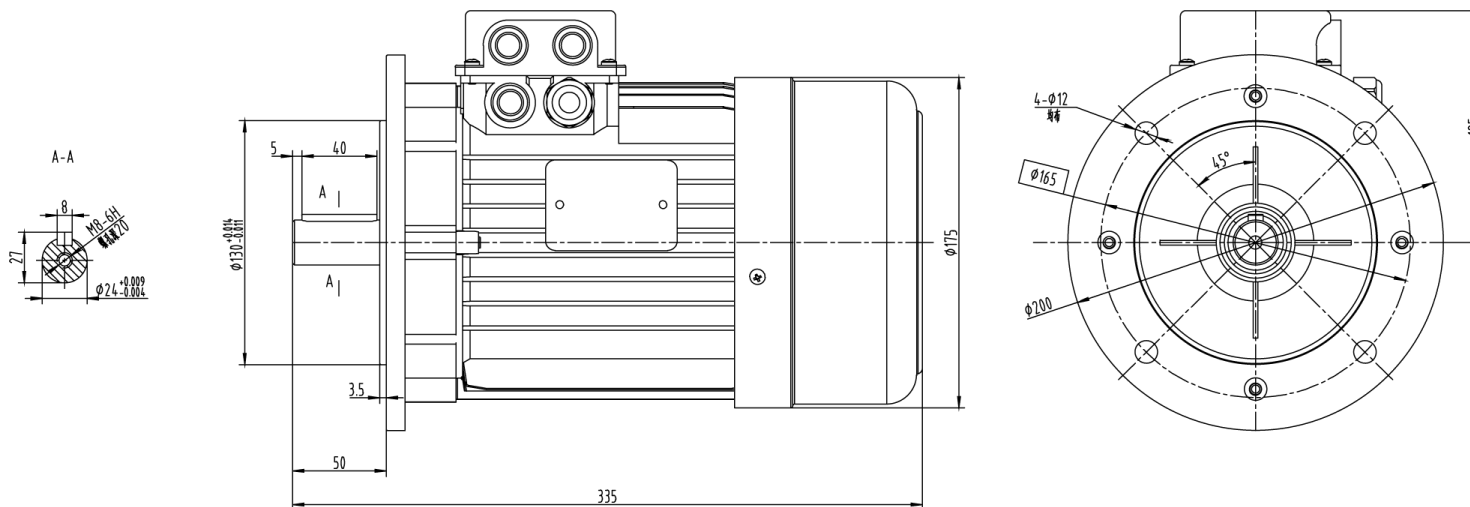

MS100LC2 B14

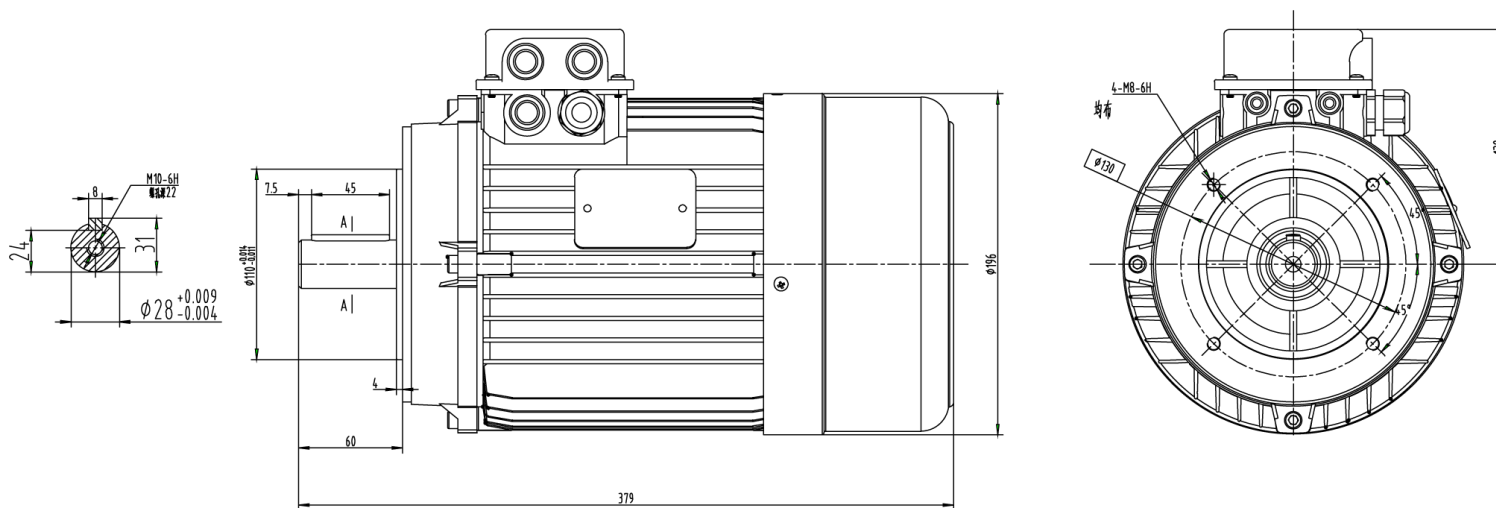

# 产品外形图

Outline Drawings

## MT132SB2/SC2 B3

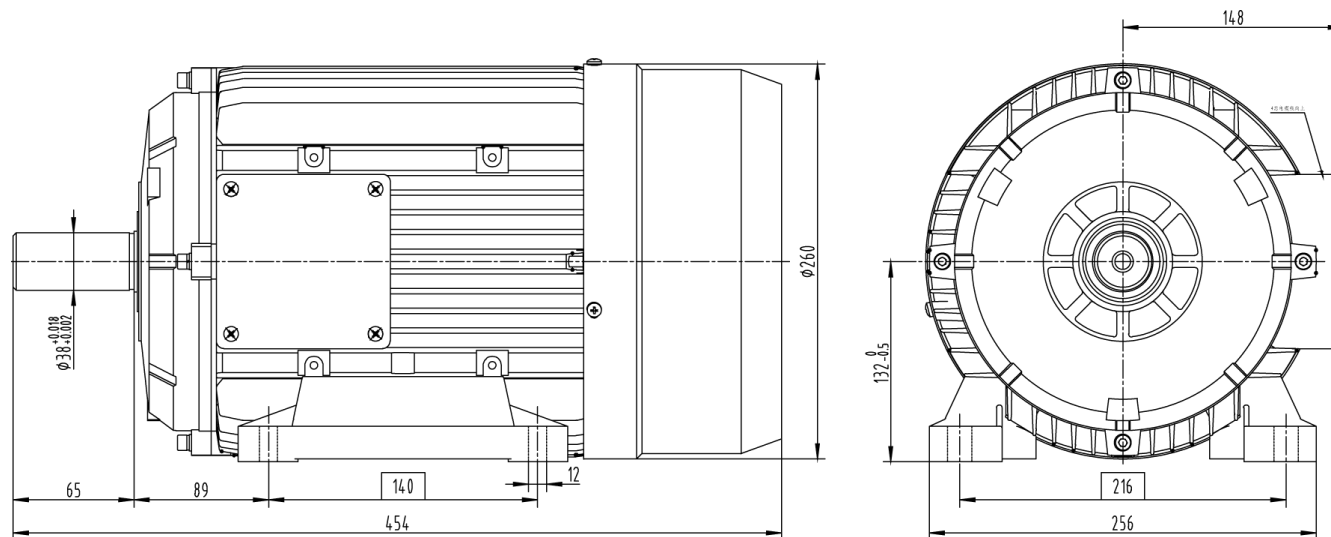

## MT132SB2/SC2 B5

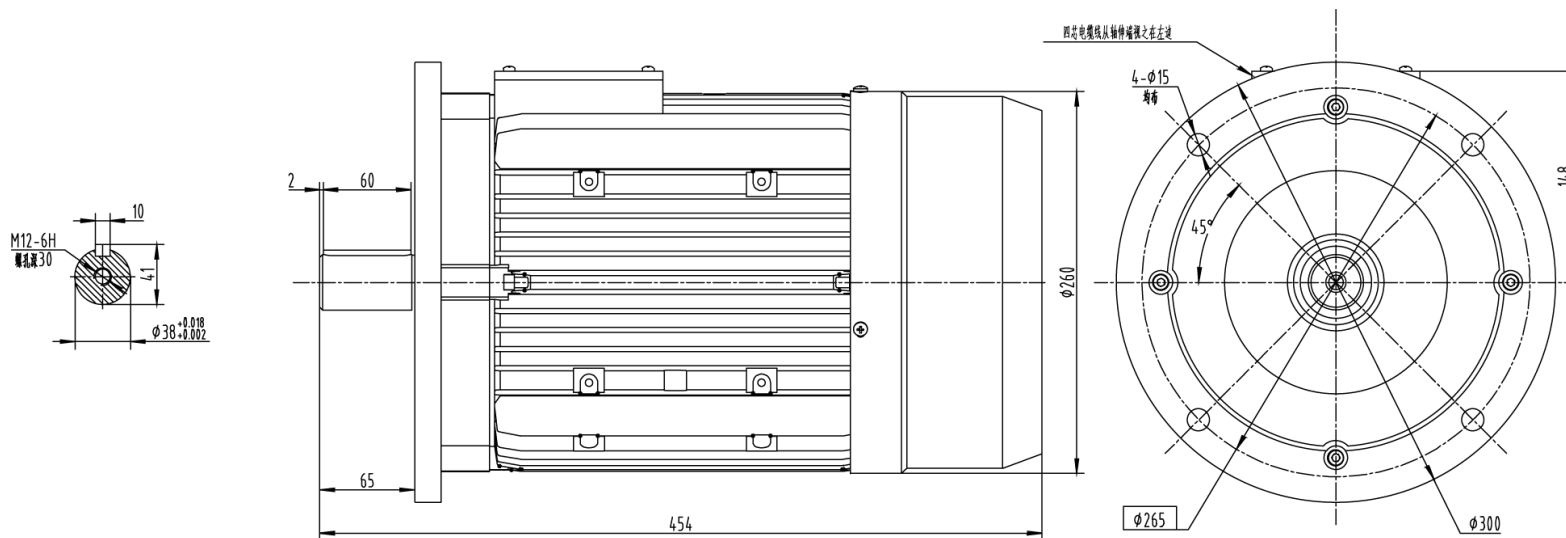

# 产品外形图

Outline Drawings

## MT132MD2 B5

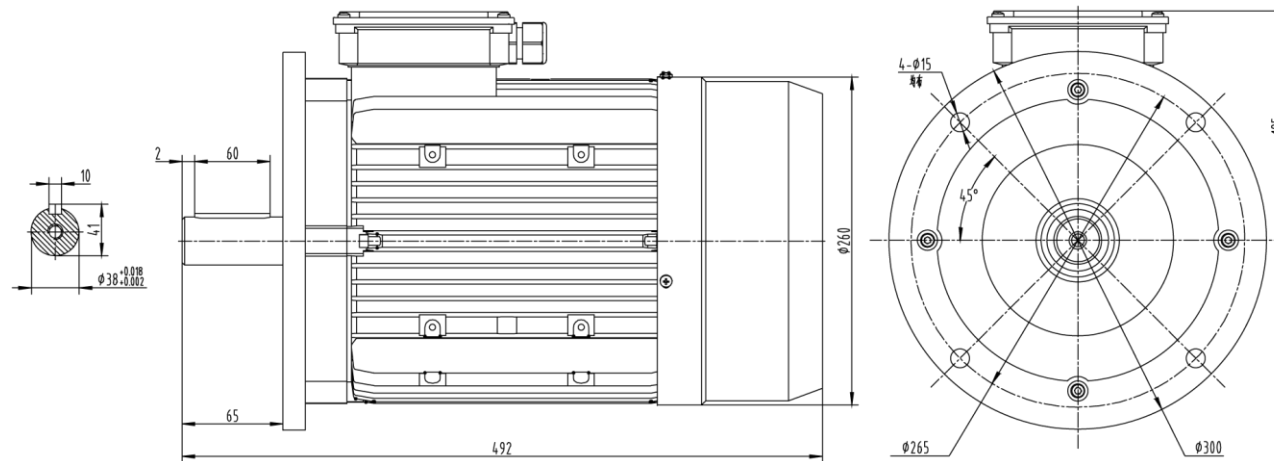

## RMS112MC2 B5

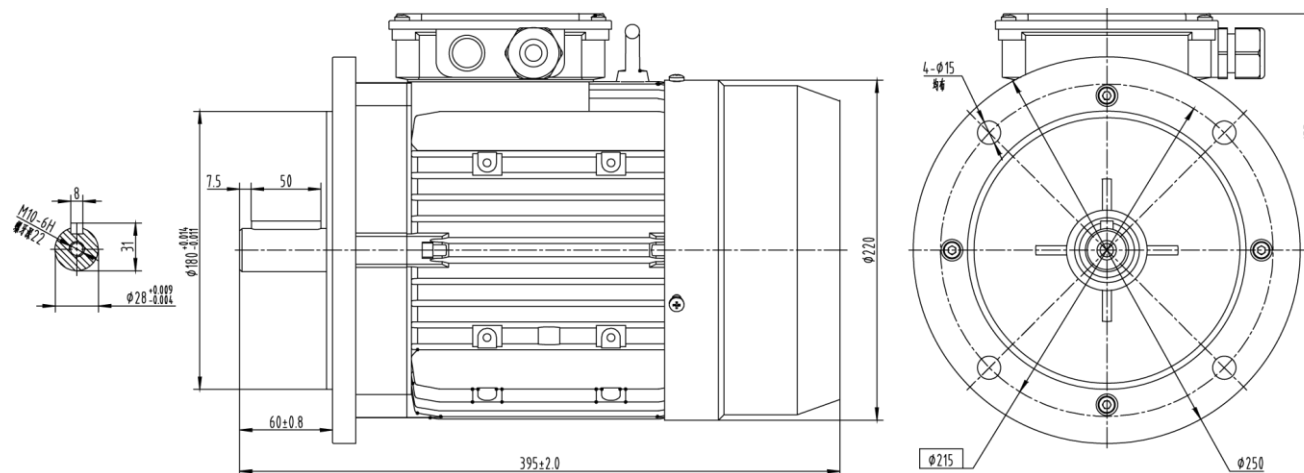

SWEA112/132 B3

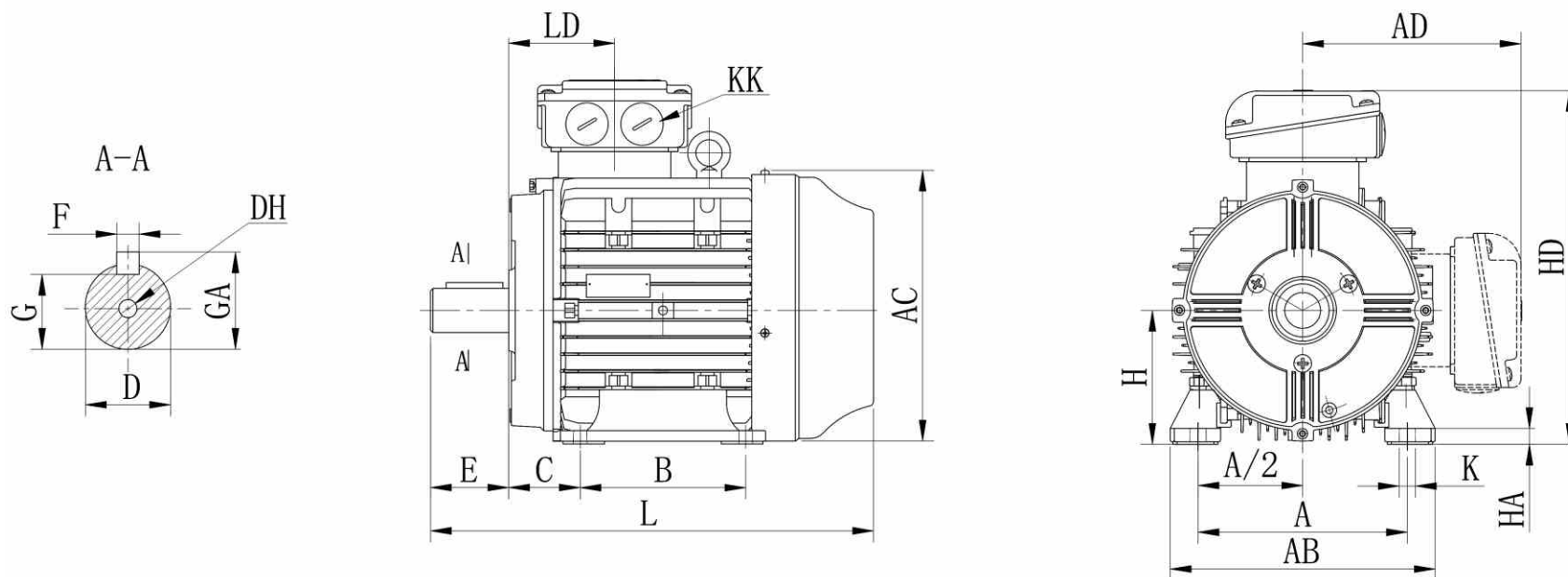

型号 Motor Type	A	B	C	D	DH	E	F	G	H	K	KK	AB	AC	AD	HD	GA	LD	HA	L
SWEA112	190	140	70	28	M10*22	60	8	24.0	112	4-Φ12	M25*1.5	230	222	169	281	31	85	12	380
SWEA132S	216	140	89	38	M12*28	80	10	33.0	132	4-Φ12	M32*1.5	264	260	193	325	41	129	15	475

# 产品外形图

Outline Drawings

## RMC8022 B3

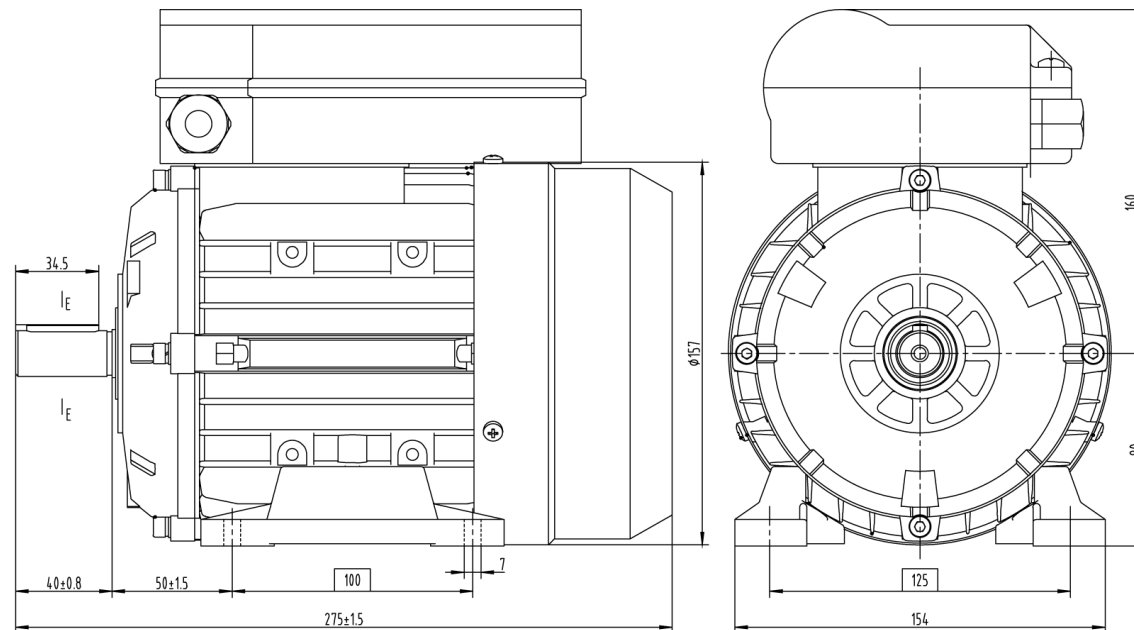
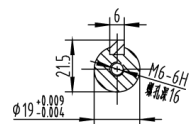

## ML100L2 B5

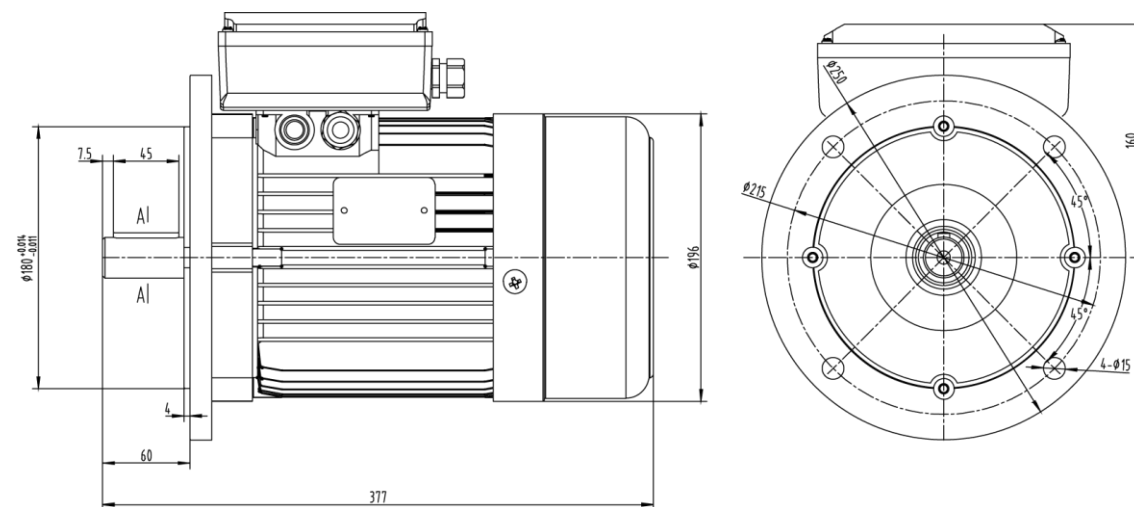
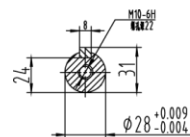



# 了解更多信息，欢迎联系WONDER!

## **福建万达电机有限公司 Wonder Electric (Fu' an)**

联系电话/Tel: +86-593-6379666 6379988

企业邮箱/Email: wonder@dayu-casting.com

网站/Web: www.wonder-cn.com

地址/Add: 福建省福安电机电器工业区兴达路239号/No.239 Xingda Rd, Electrical Machinery And Appliances Zone, Fu' an, Fujian ,China

## **福州万德电气有限公司 Wonder Electric (Fuzhou)**

联系电话/Tel: +86-591-83998899

企业邮箱/Email: wonder@wonderfz.com

网站/Web: www.wonderfz.com

地址/Add: 福建省福州市经济开发区长安投资区长洋路120号/No. 120, Changyang Rd, Chang An Investment District, Fuzhou Development Zone, Fujian, China